

SMARTRANGE™

FIRE PREVENTION PRODUCTS

INSTALLATION MANUAL



SUMMARY

SmartRange helps prevent cooking fires before they can happen. Automatically shuts off when a cooking fire risk is detected. Compatible with all electric ranges.

CONTACT

1.800.433.6026
support@pioneeringtech.com
pioneeringtech.com

Pioneering Technology Corp.
2400 Skymark Ave., Unit 7
Mississauga, Ontario, CANADA L4W 5K5

COMPATIBILITY

All electric ranges including glass top, coil and induction.

For installations that:

1. Prevent the Heat Sensor from being installed directly to the underside of the rangehood or an over-the-range microwave, or allow for less than 18" of clearance between the range and the rangehood:

Please contact your Pioneering Technology representative for custom installation assistance.

- For indoor use only • Not suitable for use in professional kitchens. • Disconnect power before installation • Ensure correct Heat Sensor location • Carry out test alarm.

STEP 1 - INSTALLING THE HEAT SENSOR

Install the Heat Sensor to the underside of the rangehood or the underside of the over-the-range microwave (OTR).

Note: Centre the Heat Sensor so it points as directly as possible to the centre of the range.

Keep the Heat Sensor a minimum of 1cm away from any rangehood lights. Ensure that the Sensor is attached to a flat, horizontal portion of the rangehood or OTR. Mounting surface should be clean and grease-free.

1. Ensure the Heat Sensor is at room temperature. Peel off the protective backing from the Sensor's mounting plate and attach the Sensor to the underside of the rangehood or OTR microwave. Ensure that the LED side of the Sensor faces you (Image 1). Remove the Sensor from the magnetic plate (Sensor will emit a beep). Check to ensure that the mounting plate is firmly secured by pressing on it.
2. Remove the red battery disconnection tab from the Heat Sensor (Image 2). SAVE RED TAB. It may be required for future use. Reattach Heat Sensor to the mounting plate, be sure the holes in the mounting plate align with the holes in the Sensor.

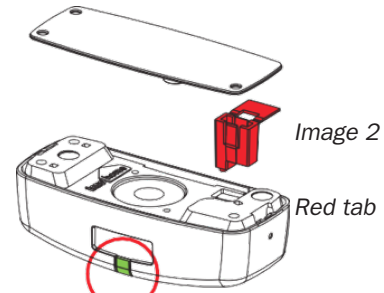

3. The Heat Sensor and the Control Unit are factory paired. If the distance from the top of the range to the Heat Sensor is greater than 24" but less than 36", please refer to the SmartRange User Guide for adjustments to the Heat Sensor's sensitivity level.
4. If the distance from the top of the range to the Heat Sensor is greater than 36" please contact your Pioneering Technology representative for custom installation assistance.

STEP 2 - INSTALLING THE CONTROL UNIT

Turn off power at the electric breaker. Pull out the stove and disconnect the stove's power cord from power outlet. Plug range into the Control Unit and plug the Control Unit into the power outlet. Return stove to original position.



Control Unit

STEP 3 - TESTING SMARTRANGE

1. Restore power at the breaker panel. Wait for Control Unit to emit a ringing sound (approx. 30 seconds), then press and hold the Heat Sensor cover until it emits a beep.
2. Control Unit will emit a ringing sound (approx. 15 seconds). After a moment, the Heat Sensor will emit an alarm signal. When the alarm signals, press Heat Sensor once.
3. Range is now operational. The installation is complete you are ready to cook safely.

**NOTE: SmartRange is not a substitute for smart cooking behaviour.
NEVER LEAVE COOKING UNATTENDED!**

TROUBLESHOOTING

1. Issue: The Heat Sensor does not respond (green light should illuminate) when pressing the cover.
Resolution: Check that the red battery disconnection tab has been removed.
2. Issue: The test alarm does not reset.
Resolution: First, try another test alarm and wait for five seconds before resetting. If the test alarm still does not reset, the Heat Sensor and the Control Unit pairing must be carried out again. (See Chapter 3.3 of Reference Manual that comes in the box with the product. The Reference Manual is also available online at www.pioneeringtech.com and reference any other info to provide the specific location of where it is located.)

The Heat Sensor and the Control Unit are factory paired. If an unpaired Heat Sensor is being used, please contact your Pioneering Technology representative for custom installation assistance.

CUSTOM INSTALLATIONS

Custom Installations are required when:

- Ranges that are wider than 36”;
- Where the distance between the range and rangehood or OTR is less than 18” or greater than 36”;
- Where there is no rangehood or OTR and the Heat Sensor must be secured to a wall.

For assistance with a custom installation, or for assistance with any installation related questions please contact your Pioneering Technology representative or email us at: info@pioneeringtech.com or call us directly at 1.800.433.6062.

